



## the Delta User Manual

### Notice for Use

Thank you for choosing Joyetech! To ensure safe and proper usage, please read this manual carefully. If you require any additional information or have any questions regarding this product or its use, please consult your local Joyetech retailer, or visit our website at [www.joyetech.com](http://www.joyetech.com).

### Product Introduction

The 6ml large volume and three adjustments of air inflow highlight the Delta. Replaceable mouthpiece and atomizer head are available on Delta due to its new atomizer head, the C3 atomizer head. The C3 atomizer head boasts triple coils with the resistance of 1.4ohm, which ensures the large amount of vapor under high voltage(4.0V-6.0V) and high wattage(11.5W-26.0W), being compatible with most high-wattage batteries in the market. Not only that, but the Delta features three glass liquid-windows, making the liquid volume more open-and-shut. Regarding its material, the all stainless steel construction creates an environmental puff.

### Standard Configuration

- 1× Delta Mouthpiece
- 1×Delta Atomizer Tube
- 2× C3 atomizer head
- 1× Delta Atomizer Base

### Features of Delta spare parts

Size: 23mm\*87.8mm(including mouthpiece and base)

Delta Mouthpiece: pluggable, plastic, replaceable

C3 Atomizer Head: rotatory, replaceable, triple coils at bottom

Delta Atomizer Tube: all stainless steel construction

Delta Atomizer Base: all stainless steel construction

### How to Assemble

1. Screw the C3 atomizer head onto the Delta atomizer base along the clockwise.
2. Screw the base onto the Delta atomizer tube along the counterclockwise.
3. Plug on the replaceable mouthpiece.

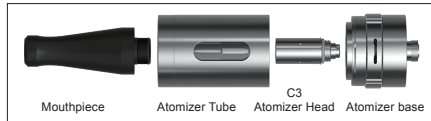

### Liquid filling

Unscrew the atomizer tube from the Delta base.

Simply refill e-Liquid into the hole from the bottom along the inwall of Delta atomizer tube.

### How to Use

360° Adjustment of air inflow: Rotating the ring on the atomizer base clockwise or counterclockwise to adjust the inlet valve. There are three slots on the atomizer base, and they



respectively represent the different air inflow, from small to large.

### Several key points:

- Please do not refill the e-liquid into the small hole in the center of the atomizer tube.
- When you unscrew the Delta base from the atomizer tube, the atomizer head may follow to become loose, so do remember to tighten it before re-screw the atomizer base on the tube.
- Please do take ten puffs under 4.0 Voltage in first use is case that the new atomizer head get damage under high voltage mode.

### Precautions

1. Only have your Delta repaired by Joyetech. Do not attempt to repair the unit by yourself as damage or personal injury may occur.
2. Do not leave the Delta in high temperatures or damp conditions, as this may damage the device. The appropriate operation temperature is within 0°C to45°C while charging and-10°C to 60°C while in use.
3. Do not attempt to combine the Delta with parts from other brands of e-cigarettes. If it isdamaged in this way, Joyetech will not take responsibility and your warranty will be void.

### Warranty terms

Please consult your Joyetech product warranty card. We are not responsible for anydamage caused by user error. Our warranty is not valid for products purchased fromthird party vendors.

### Joyetech agrees to provide repair under warranty pursuant to the following terms and conditions:

1. This warranty provides repair free of charge for defective Joyetech brand merchandise. Warranty period is 90days from date of purchase by the end user.
2. This warranty may be void as a result of any of the following conditions:
  - \* Customer does not provide warranty card and original receipt of purchase.
  - \* Merchandise failure or damage is caused due to improper use or unauthorized repair.
  - \* Merchandise failure or damage as a result of excessive force such as dropping.
  - \* Merchandise failure or damage as a result of usage outside of recommended operating conditions (see precautions in usage manual).
  - \* Merchandise failure or damage caused by improper use of water or other liquid (see usage manual foroperating instructions).
  - \* Merchandise failure or damage due to usage with non-Joyetech components (charger, battery, and power cable).
3. This warranty does not cover personal items or consumable goods and attachments, including but not limitedto: mouthpiece, cartridge, atomizer head, lanyard, and leather sheath.
4. This warranty does not cover any non-Joyetech brand products. This warranty is only valid for eligible Joyetechbrand products during the warranty period of 90 days after date of purchase as indicated on proof of purchase.

**Joyetech reserves the right of final decision in all warranty cases.  
Joyetech may interpret and revise thecontent of this warranty terms.**

MADE IN CHINA

Joyetech (Shenzhen) Electronics Co., Ltd.  
Email:[info@joyetech.com](mailto:info@joyetech.com)





## Delta 16 Atomizer Manual

### Notice for Use

Thank you for choosing Joyetech! To ensure safe and proper usage, please read this manual carefully. If you require any additional information or have any questions regarding this product or its use, please consult your local Joyetech retailer, or visit our website at [www.joyetech.com](http://www.joyetech.com).

### Product Introduction

The 3.2 large e-juice volume and slim figure highlight the Delta 16. Heat-resistant mouthpiece and C3 Dual atomizer head are available on Delta 16. Not only that, but the Delta 16 features three glass e-juice windows with stainless steel construction, which makes the liquid volume more open-and-shut.

### Specification

#### Delta 16

Size: 16.5mm\*80mm(including mouthpiece and base)

Capacity: 3.2ml

Color: Black, Silver

#### C3 Dual Atomizer Head

Size: 8.5\*20.6mm

Resistance: 1.6ohm

Working voltage range: 3.5-5.5V

Working wattage range: 6.8-16.8W

### How to use

#### Liquid filling

Unscrew the atomizer tube from the Delta 16 base and inject the liquid directly into the cambered slot. (NOTE: Please do not overfill. Leave a small air pocket in order to avoid leakage.)

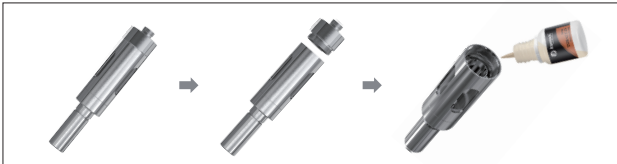

#### Atomizer Head replacement

Unscrew the atomizer cone, the atomizer head is located on the base, just unscrew it and replace and clean. (NOTE: Please do not wash the atomizer head with water. Simply scrub it with alcohol cotton or clean dry cloth.)

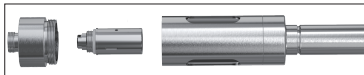

### Several key points

1. Please do not refill the e-liquid into the small hole in the center of the atomizer tube.
2. When you unscrew the Delta 16 base from the atomizer tube, the atomizer head may follow to become loose, so do remember to tighten it before re-screw the atomizer base on the tube.
3. Please do take ten puffs under 4.0 Voltage in first use is case that the new atomizer head get damage under high voltage mode.

### Precautions

1. Only have your Delta 16 repaired by Joyetech. Do not attempt to repair the unit by yourself as damage or personal injury may occur.
2. Do not leave the Delta 16 in high temperatures or damp conditions, as this may damage the device. The appropriate operation temperature is within 0 C to 45 C .
3. Do not attempt to combine the Delta 16 with parts from other brands of e-cigarettes. If it is damaged in this way, Joyetech will not take responsibility and your warranty will be void.

### Warranty terms

Please consult your Joyetech product warranty card. We are not responsible for any damage caused by user error. Our warranty is not valid for products purchased from third party vendors.

### Joyetech agrees to provide repair under warranty pursuant to the following terms and conditions:

1. This warranty provides repair free of charge for defective Joyetech brand merchandise. Warranty period is 90days from date of purchase by the end user.
2. This warranty may be void as a result of any of the following conditions:
  - \* Customer does not provide warranty card and original receipt of purchase.
  - \* Merchandise failure or damage is caused due to improper use or unauthorized repair.
  - \* Merchandise failure or damage as a result of excessive force such as dropping.
  - \* Merchandise failure or damage as a result of usage outside of recommended operating conditions (see precautions in usage manual).
  - \* Merchandise failure or damage caused by improper use of water or other liquid (see usage manual for operating instructions).
  - \* Merchandise failure or damage due to usage with non-Joyetech components (charger, battery, and power cable).
3. This warranty does not cover personal items or consumable goods and attachments, including but not limited to: mouthpiece, cartridge, atomizer head, lanyard, and leather sheath.
4. This warranty does not cover any non-Joyetech brand products. This warranty is only valid for eligible Joyetech brand products during the warranty period of 90 days after date of purchase as indicated on proof of purchase.

Joyetech reserves the right of final decision in all warranty cases. Joyetech may interpret and revise the content of this warranty terms.

MADE IN CHINA



Joyetech (Shenzhen) Electronics Co., Ltd.  
Email: [info@joyetech.com](mailto:info@joyetech.com)



## the Delta 19 User Manual

### Notice for Use

Thank you for choosing Joyetech! To ensure safe and proper usage, please read this manual carefully. If you require any additional information or have any questions regarding this product or its use, please consult your local Joyetech retailer, or visit our website at [www.joyetech.com](http://www.joyetech.com).

### Product Introduction

The 3.5 large e-juice volume and two adjustments of air inflow highlight the Delta 19. Replaceable mouthpiece and atomizer head are available on Delta 19 due to C3 Dual atomizer head. Not only that, but the Delta 19 features three glass e-juice windows, making the liquid volume more open-and-shut. Regarding to its material, the all stainless steel construction creates an environmental puff.

### Specification

#### Delta 19:

Size: 23mm\*87.8mm(including mouthpiece and base)

Capacity: 3.5ml

Color: Black, Silver

#### C3 Dual Atomizer Head:

Size: 8.5\*20.6mm

Resistance: 1.6ohm

Working voltage range: 3.5-5.5V

Working wattage range: 6.8-16.8W

### How to Assemble

1. Screw the C3 atomizer head onto the Delta 19 atomizer base along the clockwise.
2. Screw the base onto the Delta 19 atomizer tube along the counterclockwise.
3. Plug on the replaceable mouthpiece.

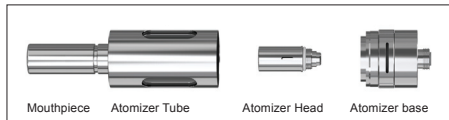

### How to Use

**360°Adjustment of air inflow:** Rotating the ring on the atomizer base clockwise or counterclockwise to adjust the inlet valve.

There are two slots on the atomizer base. The less the slot be obscured by, the bigger the air inflow is.

### Liquid filling

Unscrew the atomizer tube from the Delta 19 base. Simply refill e-Liquid into the hole from the bottom along the inwall of Delta 19 atomizer tube.

### Several key points:

- Please do not refill the e-liquid into the small hole in the center of the atomizer tube.
- When you unscrew the Delta 19 base from the atomizer tube, the atomizer



head may follow to become loose, so do remember to tighten it before re-screw the atomizer base on the tube.

- Please do take ten puffs under 4.0 Voltage in first use is case that the new atomizer head get damage under high voltage mode.

### Precautions

1. Only have your Delta 19 repaired by Joyetech. Do not attempt to repair the unit by yourself as damage or personal injury may occur.
2. Do not leave the Delta 19 in high temperatures or damp conditions, as this may damage the device. The appropriate operation temperature is within 0°C to 45°C.
3. Do not attempt to combine the Delta 19 with parts from other brands of e-cigarettes. If it is damaged in this way, Joyetech will not take responsibility and your warranty will be void.

### Warranty terms

Please consult your Joyetech product warranty card. We are not responsible for any damage caused by user error. Our warranty is not valid for products purchased from third party vendors.

### Joyetech agrees to provide repair under warranty pursuant to the following terms and conditions:

1. This warranty provides repair free of charge for defective Joyetech brand merchandise. Warranty period is 90 days from date of purchase by the end user.

2. This warranty may be void as a result of any of the following conditions:

- \* Customer does not provide warranty card and original receipt of purchase.
- \* Merchandise failure or damage is caused due to improper use or unauthorized repair.
- \* Merchandise failure or damage as a result of excessive force such as dropping.
- \* Merchandise failure or damage as a result of usage outside of recommended operating conditions (see precautions in usage manual).
- \* Merchandise failure or damage caused by improper use of water or other liquid (see usage manual for operating instructions).
- \* Merchandise failure or damage due to usage with non-Joyetech components (charger, battery, and power cable).

3. This warranty does not cover personal items or consumable goods and attachments, including but not limited to: mouthpiece, cartridge, atomizer head, lanyard, and leather sheath.

4. This warranty does not cover any non-Joyetech brand products. This warranty is only valid for eligible Joyetech brand products during the warranty period of 90 days after date of purchase as indicated on proof of purchase.

**Joyetech reserves the right of final decision in all warranty cases. Joyetech may interpret and revise the content of this warranty terms.**

MADE IN CHINA

Joyetech (Shenzhen) Electronics Co., Ltd.  
Email: [info@joyetech.com](mailto:info@joyetech.com)

